



Hydraulic Torque Wrench Drive and Hollow Model

Product Descriptions

Kertz hydraulic torque wrench is a high-precision, industrial-grade tool used for applying controlled torque to fasteners such as bolts and nuts. It operates using hydraulic pressure to generate force, ensuring accurate and consistent torque application. These wrenches are commonly used in industries such as oil and gas, power generation, construction, and heavy equipment maintenance.

Function:

Kertz hydraulic torque wrenches work by utilizing hydraulic pressure to apply a precise amount of torque to a fastener. They typically consist of a hydraulic pump, a reaction arm, and a drive mechanism that fits onto the bolt or nut. When activated, the hydraulic system drives the wrench, applying a controlled rotational force that tightens or loosens the fastener according to the specified torque settings.

Benefits:

- 1.High Precision – Ensures accurate torque application, reducing the risk of over-tightening or under-tightening.
- 2.Consistent Performance – Provides uniform torque across multiple fasteners, improving joint reliability.
- 3.Enhanced Safety – Reduces operator fatigue and minimizes the risk of injuries compared to manual torque wrenches.
- 4.High Torque Capability – Suitable for large bolts and high-load applications where manual tools are insufficient.
- 5.Versatility – Can be used in various industries, including automotive, aerospace, and heavy machinery.
- 6.Durability – Built for rugged industrial environments with high-quality materials to withstand extreme conditions.

Model

Drive Type KHTW-D



Dimensional Drawing

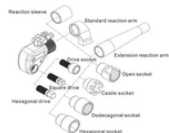

Optional CEJN self-locking quick coupler C701EL

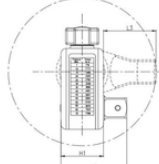
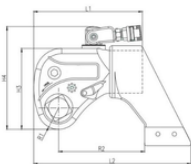

Hollow Type KHTW-H

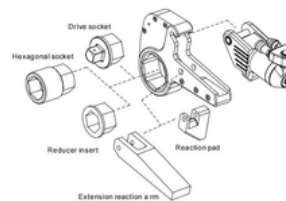

Optional CEJN self-locking quick coupler C701EL



Drive Model

KHTW-D

Features:

- The KHTW-D series square drive hydraulic torque wrench is constructed from aviation aluminum alloy, ensuring exceptional quality and durability.
- It utilizes an advanced precision ratchet drive, achieving higher torque output accuracy with a maximum repetitive torque of $\pm 3\%$.
- This tool boasts a wide operational range, with a maximum working pressure of 70MPa, and offers 12 models featuring torque capacities from 185Nm to 160,000Nm.
- The KHTW-D square torque wrench is equipped with a $360^\circ \times 180^\circ$ rotary tubing joint, allowing for versatile applications. The $360^\circ \times 180^\circ$ trigger lock enables placement of the fine-tuning reaction arm on any fulcrum.
- Its direct-push drive shaft design facilitates quick transitions between tightening and disassembly, while the locking drive shaft can be customized to meet your specific needs.
- The KHTW-D square head size of the square drive hydraulic wrench ranges from $3/4"$ to $4"$, compatible with KSDS's specialized square drive socket, making it suitable for various bolt specifications.



Main Features :

- High Quality Material of CEJN Quick Couplers
 - Benefit: Ensures reliable and leak-free hydraulic connections, reducing downtime and improving operational safety.
- Al-Ti Alloy Material, Integrated Design
 - Benefit: Combines aluminum and titanium for a lightweight yet highly durable construction, enhancing strength while minimizing operator fatigue.
- $360^\circ \times 180^\circ$ Degree Swivel Joint (No Space Limitation)
 - Benefit: Provides flexibility in tight or hard-to-reach areas, allowing for easy positioning without hose interference.
- 360° Degree Reaction Arm
 - Benefit: Enables secure and stable torque application by adjusting to different support positions, improving safety and efficiency.
- Square Drive Design (Easy to Convert Between Tightening and Loosening)
 - Benefit: Simplifies operation by allowing quick switching between tightening and loosening, reducing tool changeover time.
- Advanced Ratchet Drive (Torque Repeatability $\pm 3\%$)
 - Benefit: Ensures high precision and consistent torque application, reducing the risk of bolt failures due to over- or under-tightening.

Drive Model

KHTW-D

Dimensional Drawing

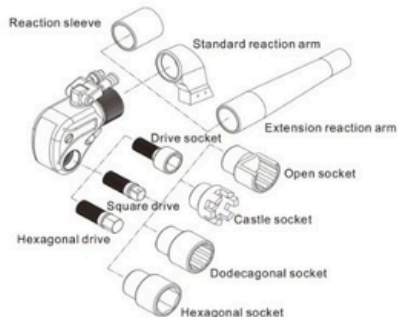

Optional CEJN self-locking quick coupler C701EL

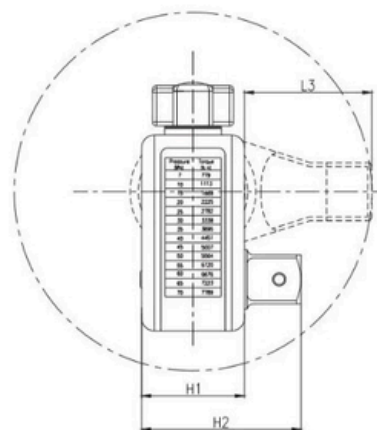
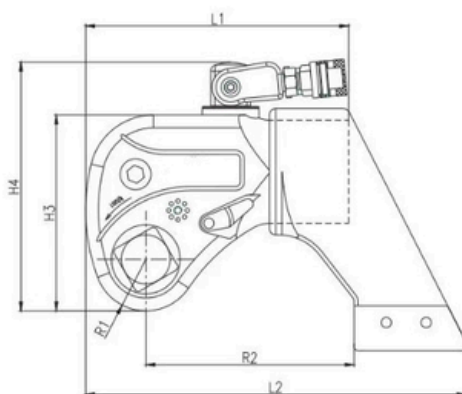

Model	KHTW-D3/4	KHTW-D1	KHTW-D2	KHTW-D3	KHTW-D4	KHTW-D5	KHTW-D6	KHTW-D7	KHTW-D8	KHTW-D9	KHTW-D10	KHTW-D11
Torque (N.m)	109	185	436	779	1072	1553	2050	2617	3493	4963	5912	7135
	1089	1852	4364	7789	10715	15528	20501	2617	34928	49627	59123	71349
Weight (kg)	1,2	2,7	4,8	8,8	12	14,5	19	25	37,5	44	63	89
L1 (mm)	107	138	168	207	226	250	281	304	331	390	412	418
L2 (mm)	150	194	244	296	326	366	402	442	483	558	570	596
H1 (mm)	42	50	70	80	90	100	112	120	138	150	163	166
H2 (mm)	63	73	99	124	133	143	165	183	202	219	228	232
H3 (mm)	81	96	125	152	170	186	208	226	250	282	288	300
H4 (mm)	127	140	165	193	211	227	249	267	291	323	332	359
R1 (mm)	21	26	34	40	46	50	56	60	66	77	80	82
R2 (mm)	81	107	132	162	178	199	218	240	260	298	303	325
Drive	3/4"	3/4"	1"	1-1/2"	1-1/2"	1-1/2"	2"	2-1/2"	2-1/2"	2-1/2"	2-1/2"	3"

Hollow Model

KHTW-H

Features:

- The KHTW-H series Hollow hydraulic torque wrench adopts an integrated design and is made of aluminum-titanium alloy, which makes it stronger and tougher.
- The working head and fulcrum of SHW Hollow hydraulic torque wrench are coaxial, with perfect structure and long service life. One power head can match different working heads.
- KHTW-H Hollow hydraulic torque wrench can run smoothly under a pressure of 70MPa, and have high accuracy, with a torque repeatability of $\pm 3\%$. The 360 \times 180 degree rotary joint allows it to be operated more freely in any small space.
- There are 11 models of TYD SHW Hollow hydraulic torque wrench, with a very wide torque range from 237Nm to 85000Nm.
- KHTW-H Hollow hydraulic torque wrench are packaged in double layers, with aluminum-plastic boxes and wooden boxes.



Main Features :

- High Quality Material of CEJN Quick Couplers
 - Benefit: Ensures reliable and leak-free hydraulic connections, reducing downtime and improving operational safety.
- Al-Ti Alloy Material, Integrated Design
 - Benefit: Combines aluminum and titanium for a lightweight yet highly durable construction, enhancing strength while minimizing operator fatigue.
- 360° x 180° Degree Swivel Joint (No Space Limitation)
 - Benefit: Provides flexibility in tight or hard-to-reach areas, allowing for easy positioning without hose interference.
- 360° Degree Reaction Arm
 - Benefit: Enables secure and stable torque application by adjusting to different support positions, improving safety and efficiency.
- Square Drive Design (Easy to Convert Between Tightening and Loosening)
 - Benefit: Simplifies operation by allowing quick switching between tightening and loosening, reducing tool changeover time.
- Advanced Ratchet Drive (Torque Repeatability $\pm 3\%$)
 - Benefit: Ensures high precision and consistent torque application, reducing the risk of bolt failures due to over- or under-tightening.

Hollow Model

KHTW-H

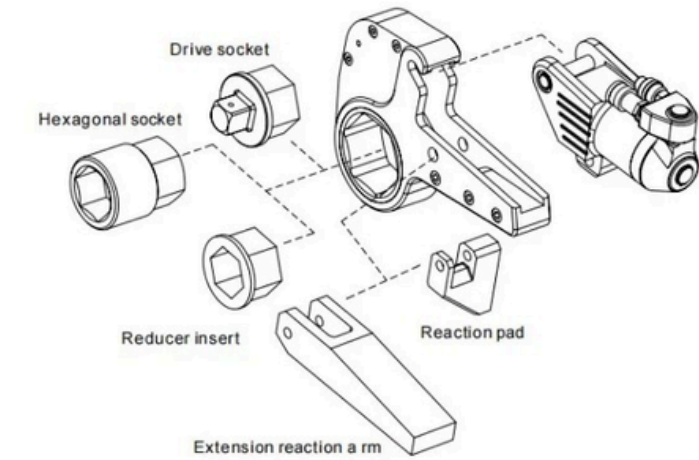

Model	KHTW-D1	KHTW-D2	KHTW-D3	KHTW-D4	KHTW-D5	KHTW-D6	KHTW-D7	KHTW-D8	KHTW-D9	KHTW-D10
Torque (N.m)	345	546	1005	1848	2481	2909	4231	5209	6057	8415
	3446	5458	10550	18484	24814	29089	42311	52088	60566	84150
Nut range S	36 - 60	46 - 80	70 - 105	80 - 115	85 - 120	90 - 130	95 - 145	120 - 145	130 - 155	135 - 180
Power Head Weight (kg)	0,8	1,9	3,3	5,5	8,1	10,5	12,7	15,2	16,3	23
Working Head Weight (kg)	1,7	3,6	6,2	11,5	23,7	25,3	32,3	47,5	58,7	75
L (mm)	218	266	324	382	404	427	479	479	486	514
H1 (mm)	118	139	171	205	229	240	268	285	311	336
H2 (mm)	156	167	198	231	255	265	289	302	352	375
W1 (mm)	32	42	53	64	68	70	85	98	105	117
W2 (mm)	50	66	83	99	105	110	132	148	160	177

Hydraulic Pump Power Pack



Electric and Pneumatic Hydraulic Pump Power Pack

- Features three pressure settings and three flow outputs that automatically switch, enhancing work efficiency.
- The standard configuration allows for the simultaneous operation of two hydraulic wrenches (custom options available to drive four at once).
- Constructed from aluminum titanium alloy, the pump body is lightweight and portable.
- The output pressure can be easily adjusted within a range of 40 to 700 bar.
- Equipped with a high-performance radiator; the fan activates when the oil temperature hits 35 °C , ensuring extended operational time.

Electric Hydraulic Power Pack

1. Model KHPP-HTW 4000 E - Single Stage Electric Hydraulic Power Pack
2. Model KHPP-HTW 2S3000 - Double Stage Electric Hydraulic Power Pack

Model	Oil Tank Capacity	Max Prasure	Flow Rate	Output Pressure	Power	Voltage	Size	Host Length	Weight
	Litre		Mpa	L/Min			Mpa		
KHPP-HTW 4000 E	7,6	70	9	6,52	1,1	220V/50Hz	40x31x44	6	28
			3,5	32					
			1,1	70					
KHPP-HTW 2S3000	8	70	6	6	1,5	220V/50Hz	43x32,5x54	6	38
			0,8	70					

Pneumatic Hydraulic Power Pack

1. Model KHPP-HTW 4000 E - Single Stage Electric Hydraulic Power Pack
2. Model KHPP-HTW 2S3000 - Double Stage Electric Hydraulic Power Pack

Model	Oil Tank Capacity	Max Prasure	Flow Rate	Output Pressure	Power	Air Pressure (bar)	Air Consumption (m³/h)	Size	Host Length	Weight
	Litre		Mpa	L/Min				Mpa		
KHPP-HTW 4000 P	7,6	70	8	6,5	1,3	4-8	134	43x28x45	6	21
			1,8	32						
			0,86	70						